

**For HID Beloader Pro version users, please follow the steps below:**

- 1:** Use [HID Manager 1.0](#) to upgrade the firmware [Beloader Pro 20230303.1745](#)
- 2:** After the upgrade is successful, remove the Beloader Pro, and then plug it into the PC (do not press the upgrade button) , after 5 seconds, then unplug.
- 3:** Enter the upgrade mode again(hold update button and insert PC)
- 4:** Please use the Microsoft Edge browser to open the index in the [Beloader pro web page 03.02 file](#)
- 5:** Connect Beloader Pro and set up

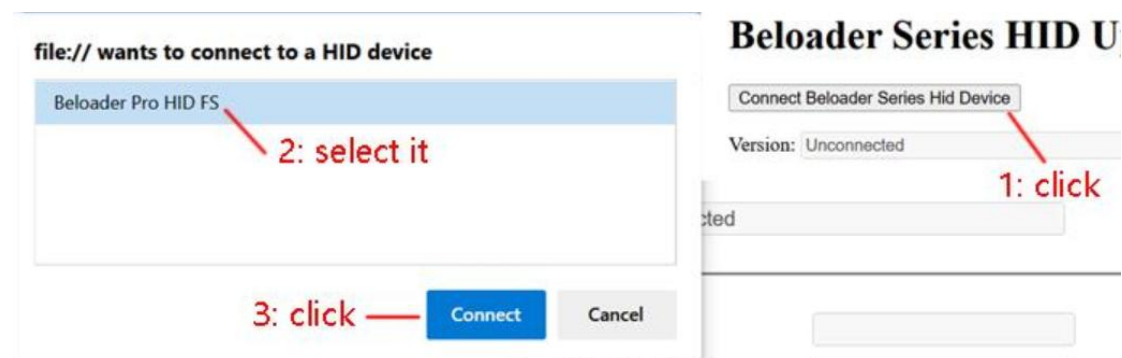

- 6:** After inputting PSN ID and PIN successfully, click SAVE
- 7:** Remove Beloader Pro, and use it normally.

Please refer to [the video](#) for the steps to connect Cronus Zen. The Zen set should:

