

For **old Beloader Pro version** users, please follow the steps below:

1: Use **Super Manager 1.4** to upgrade the firmware **Beloader Pro 20230303.1745**

2: After the upgrade is successful, remove the Beloader Pro, and then plug it into the PC (do not press the upgrade button) , after 5 seconds, then unplug.

3: Enter the upgrade mode again(hold update button and insert PC)

4: Please use the Microsoft Edge browser to open the index in the **Beloader pro web page 03.02 file**

5: Connect Beloader Pro and set up

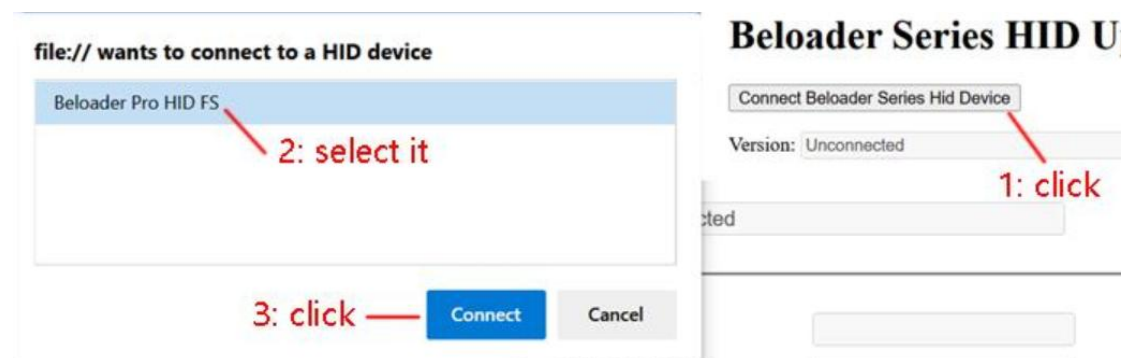

6: After inputting PSN ID and PIN successfully, click SAVE

7: Remove Beloader Pro, and use it normally.

Please refer to **the video** for the steps to connect Cronus Zen. The Zen set should:

