

Besavior P5Mate Manual

1.Introduction

Besavior P5mate uses USB wired mode to connect to PS5 console, please turn on the USB connection function of PS5 console before use:



Besavior P5mate buttons and ports have the following functions:

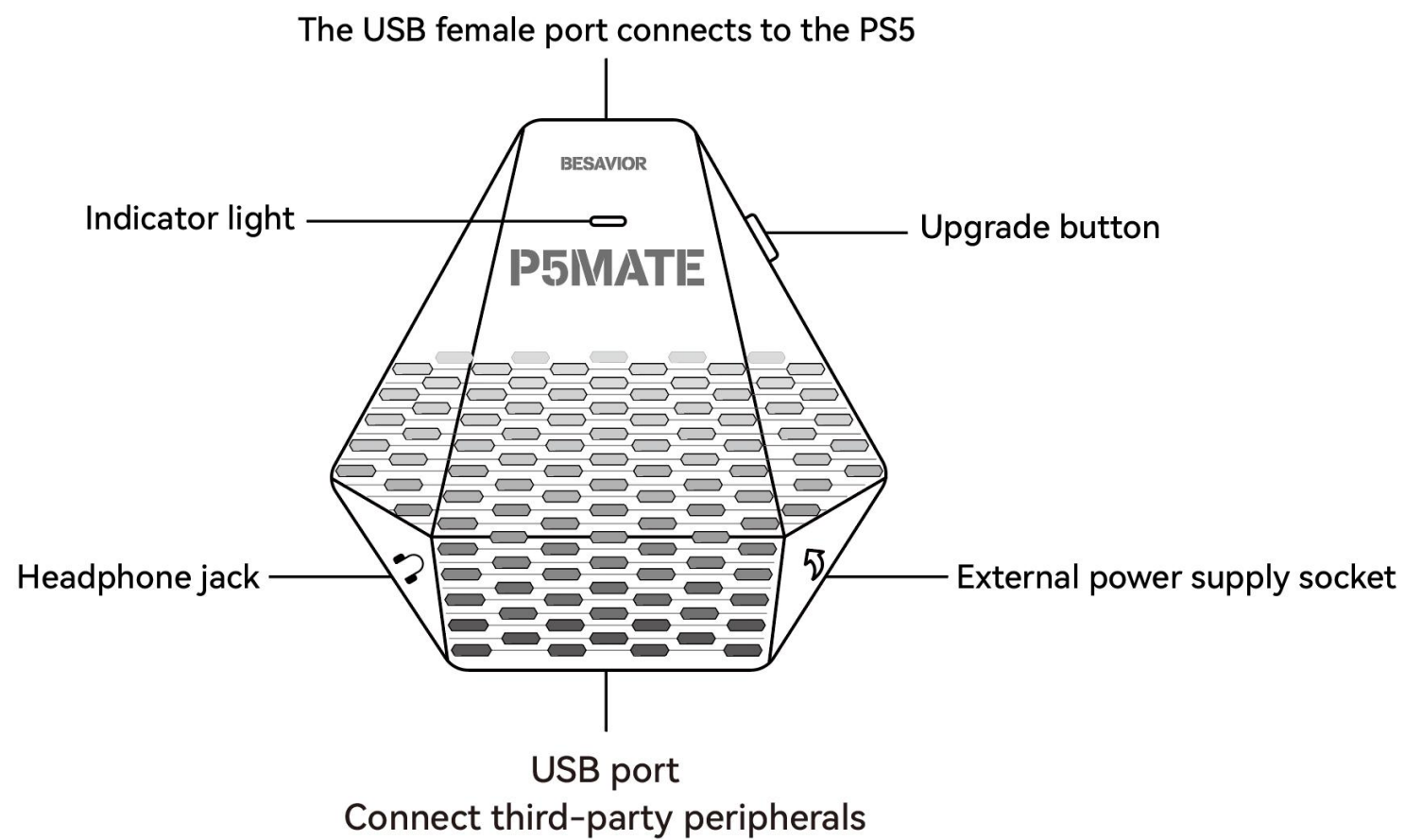

TYPE-C data Cable*1



Dual head USB cable*1

2. How to use

Follow these steps:

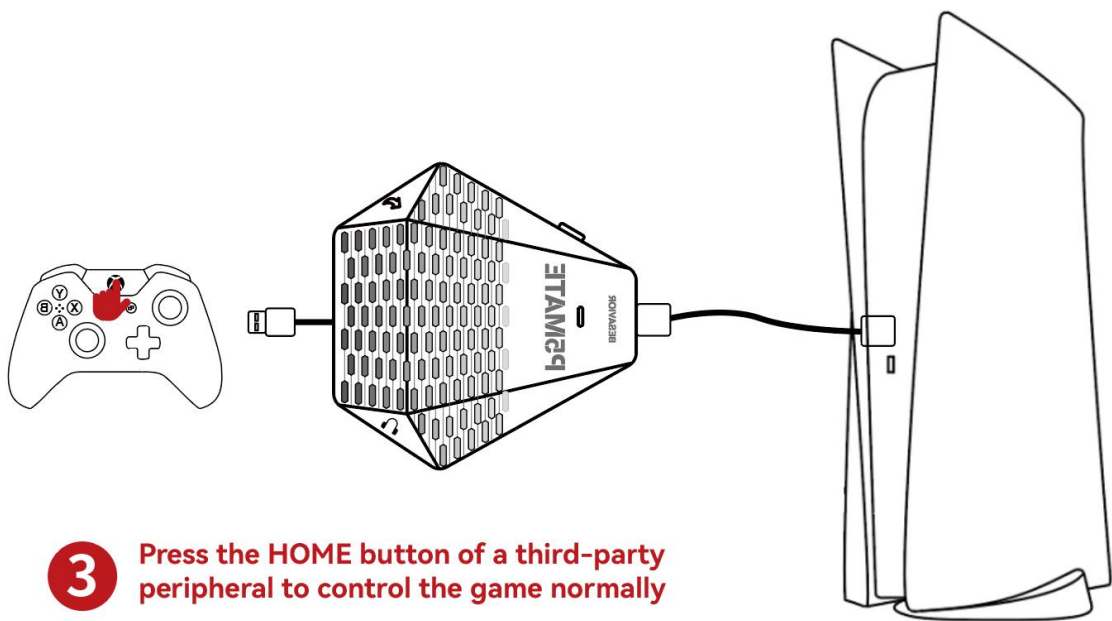
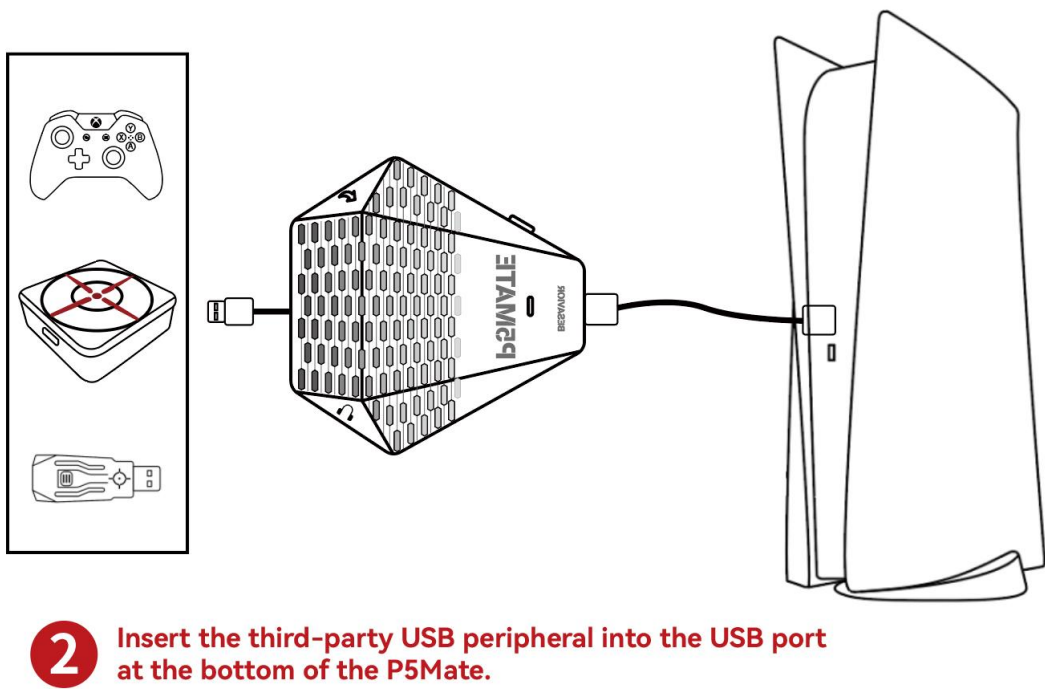
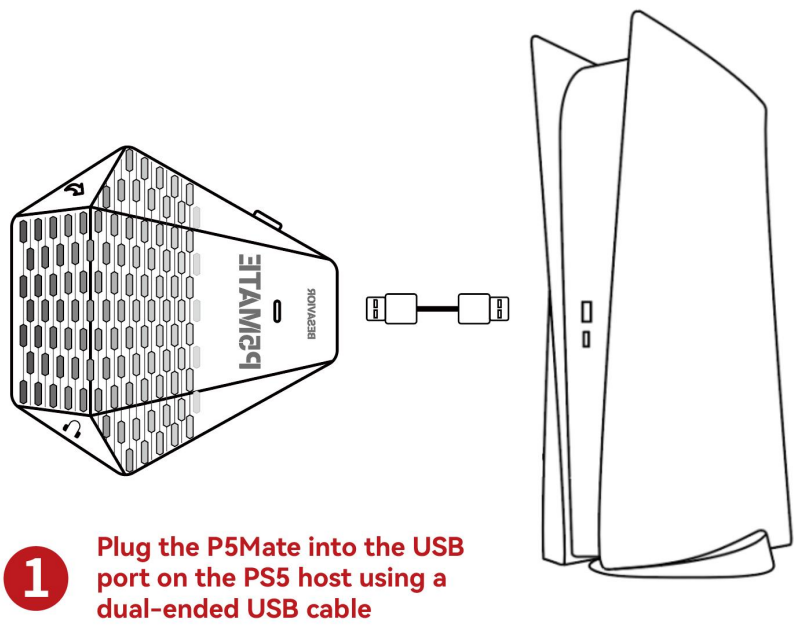

Note: In the normal working condition of P5MATE, the upgrade button press is equal to the touchpad press

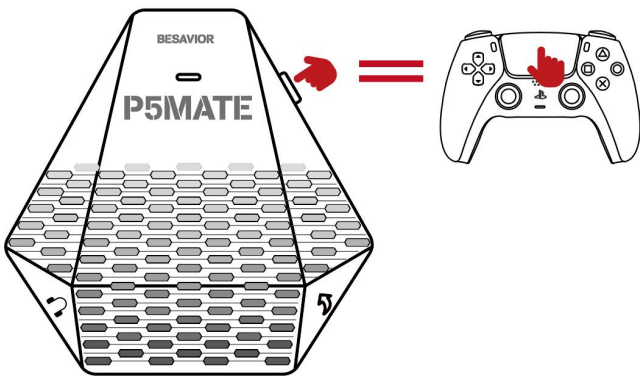

3. How to upgrade

- 1. Download the [latest upgrade software and firmware](#) from the forum of the official website and decompress them to the computer disk.
- 2. Hold down the Besavior P5Mate upgrade button () and insert the Besavior P5Mate into the USB port of your WINDOWES PC
- 3. Open the index.html in the upgrade file with your **Microsoft Edge** browser and follow these steps

Besavior P5Mate Update

Connect Besavior P5Mate Device ← 1.Click Connect

BesaviorP5Mate/index.html

update ← 2.Select update

3.Select Connect

Connect Cancel

Firmware Update

4.Click here to select the downloaded upgrade firmware

Choose File No file choosen

Update 5.Click Update to upgrade the firmware

Besavior P5Mate Update

Connect Besavior P5Mate Device

When the upgrade is complete, the corresponding version number is displayed

Version: StdFc_H0000202402121945

Go to www.Beloder.com for more video tutorials